



WILO TOP S Submittal

Top S 1.25 x 35 Three Phase Series



Pumpen Intelligenz.

Project:	
Engineer:	
Contractor:	
Submitted By:	Date:
Approved By:	Date:

Tag #	Model #	Flow	Head	Volt	Phase	Comments
	TOP S 1.25 X 35				3	
	TOP S 1.25 X 35				3	

Details	Max Hp	Pipe Size	l0	l1	l2	a1	a2	b1	b2	b4	b5	Weight
Imperial	1/4 Hp	1 1/4"	8 1/2	4 1/4	4 7/16	7 5/8	1 11/16	2 11/16	2 3/8	2 3/4	2 3/4	18.5 lbs
Metric	180 Watt	32 mm	216	108	113	193	42.5	69	60	70	70	8.4 kg

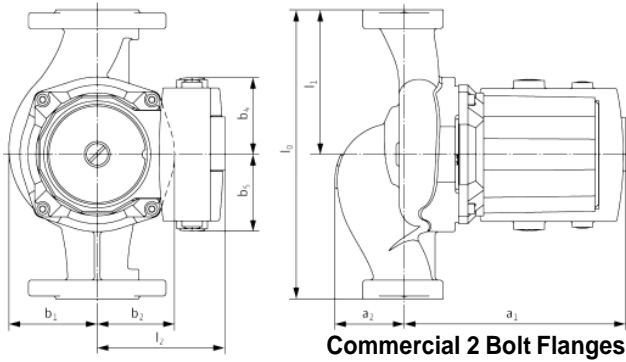

Speed	RPM	Max Watts	Amps 208/3 V	Amps 230/3 V
Max	3310	355	1.3	1.3
Min	2840	245	0.8	0.8

140 deg F (60 C)	194 deg F (90 C)	Min Inlet Pressure
1.8 PSI (12 kpa)	7.3 PSI (50 kpa)	

Operating Limits
 Max Temp 14 to 248 Deg F (- 10 to 120 Deg C)
 Max Ambient Temp 104 Deg F (40 Deg C)
 Max Working Pressure 145 PSI (10 Bar)

Materials of Construction
 Impeller Polypropylene (50% Glass Filled)
 Shaft Stainless Steel (X40 Cr13)
 Bearing Metal Impregnated Carbon
 Volute Cast Iron (Closed Systems)
 Cataphoresis Coated

