

# Submittal Data Sheet Booklet

## Range: Wilo-Stratos

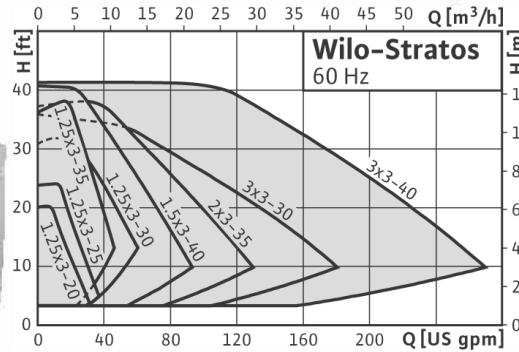

### > Single head pumps:

- Electronically controlled circulating pumps with flanged connection

### > Applications:

- Hot-water heating systems of all kinds, air conditioning, closed cooling circuits, industrial circulating systems

### > Special features:

- ECM-Technology for outstanding efficiency
- Cataphoresis coating for preventing corrosion in the event of condensation
- Maintenance free single-head circulator
- Automatically air venting

### > Product advantages:

- Energy savings up to 80% over standard pumps
- For all heating, air-conditioning and cooling systems in the temperature range of 14 °F (-10 °C) to 230 °F (+110 °C)
- Optimal handling through frontal operation and frontal access to the terminal room (face to face)
- Variable installation positions
- Reliability and comfort during installation



# WILO Stratos Submittal

## Stratos 3.0 x 3-30



Pumpen Intelligenz.

Project:							
Engineer:							
Contractor:							
Submitted By:				Date:			
Approved By:				Date:			

Tag #	Model #	Flow	Head	Volt/Phase	Control	IF Module	Comments
	Stratos 3.0 x 3-30			230/1/60			

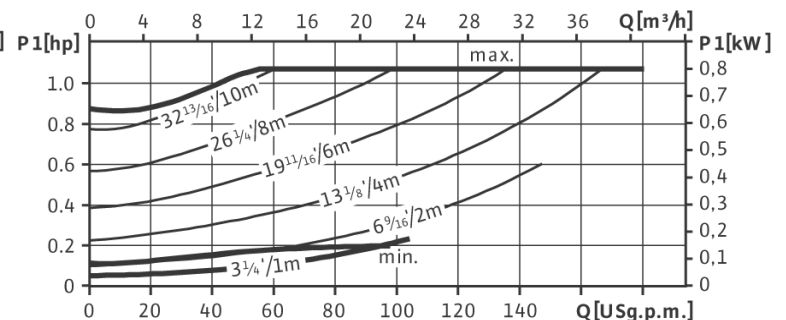
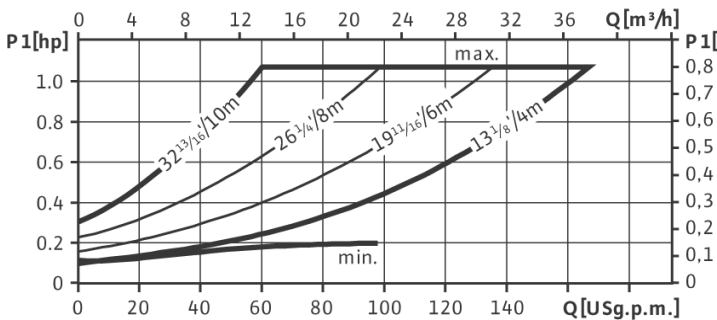
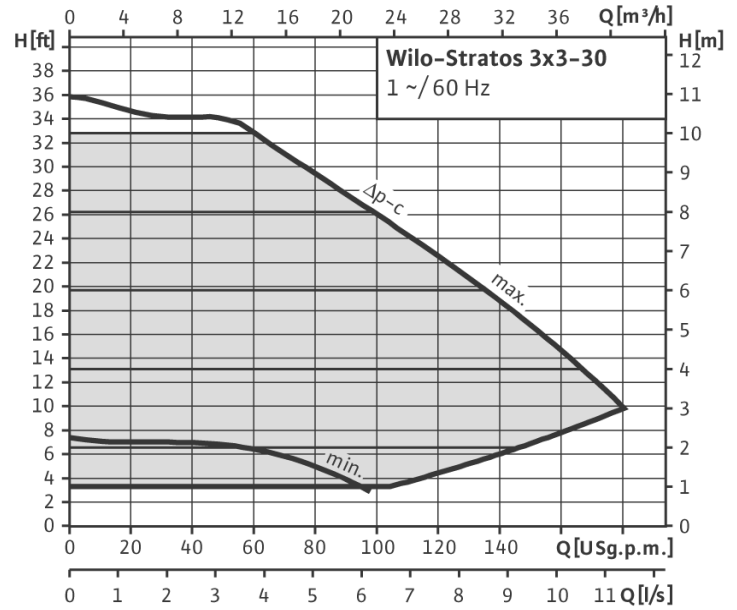
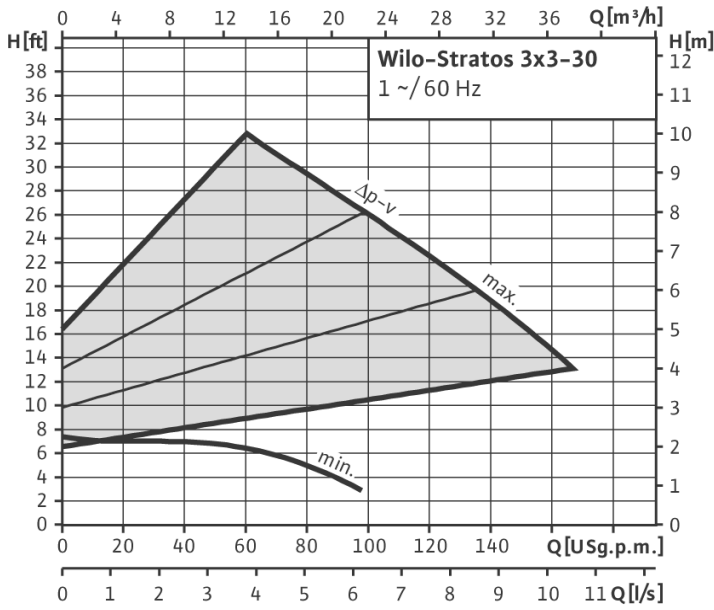

### Control Modes

- p-v Pressure Differential Variable - factory default setting (set pressure is half at zero flow)
- p-c Pressure Differential Constant (set pressure constant)
- p-t Temperature Influenced Differential Pressure Control (IR Device Required to Activate)
- Automatic Night Set Back Activated - factory default setting
- Manual Speed Control (RPM x 100)

### IF Interface Modules (optional)

- External Min/0 to 10 Volt DC (0 - 10 Vdc input remotely controls head set point or pump speed)/DP (Dual Pump)
  - External Min (control override) remote, voltfree n/c contact
- External Off/OC (Operation Contact)/DP (Dual Pump)
  - External Off (control override) remote, voltfree n/c contact,
  - Operation Contact, volt free n/o contact
- LON/DP (LonWorks BMS communication and Dual Pump)



# WILO Stratos Submittal

## Stratos 3.0 x 3-30



*Pumpen Intelligenz.*

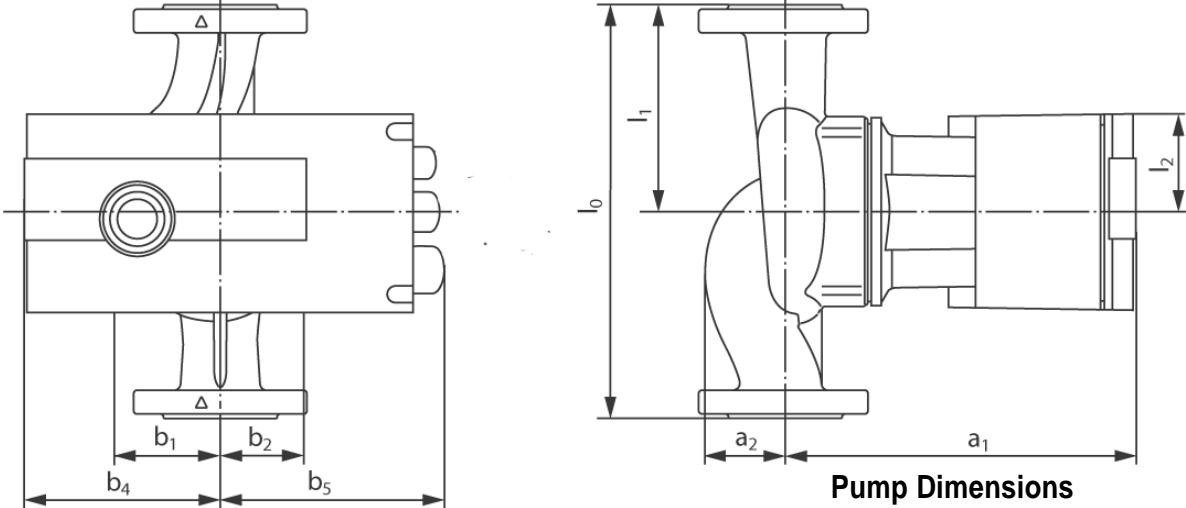

Details	Max Hp	Pipe Size	l <sub>0</sub>	l <sub>1</sub>	l <sub>2</sub>	a <sub>1</sub>	a <sub>2</sub>	b <sub>1</sub>	b <sub>2</sub>	b <sub>4</sub>	b <sub>5</sub>	Weight
Imperial	1.0 Hp	3"	14	7	3 1/16	12 13/16	3 3/8	4	3 1/4	6 1/8	6 7/16	41.9 lbs
Metric	650 Watt	80 mm	356	178	78	325	87	101	82	155	164	19.0 kg

### Flange Dimensions (3" 125 # ANSI)

Details	Flange	D	d1 (dia)	d2	k (dia)	n x dL
Imperial	3"	7 1/2	3 1/4	5	6	4 x 3/4
Metric	80 mm	192	82	128	152	4 x 19

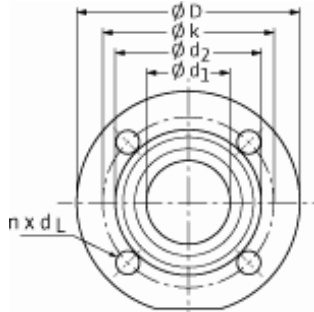

### Electrical Information

Rated Power (P2) Hp max	Rated Power (P2) Watts max	Speed Range	Consumed Power (P1) watts min/max	Amps 230/1 (and 230/3)	Motor Protection
0.872	650	950 - 3300	38 - 800	0.28 - 3.50	Integrated

### Minimum Inlet Pressure

122 deg F (50 C)	203 deg F (95 C)	230 deg F (110 C)
10.2 PSI	21.8 PSI	33.4 PSI

#### Operating Limits

Temp Min/Max 14 to 230 Deg F (- 10 to +110 Deg C)  
 Max Ambient Temp 104 Deg F (40 Deg C)  
 Max Working Press 145 PSI (10 Bar)

#### Materials of Construction

Impeller Fibreglass Reinforced PP  
 Shaft Stainless Steel (X46 Cr13)  
 Bearing Metal Impregnated Carbon  
 Volute Cast Iron, Cataphoresis Coated

#### Motor/Electronics

Power Electronics Frequency Converter - ECM Type  
 Degree of Protection Enclosure 2  
 Insulation Class H

